

# Standard Larder Cabinets

MAI00006 R0



**Note:** 'J' pull range **MUST** have tall door at top.



2310mm Cabinet



2118mm Cabinet



1414mm Cabinet

**Please read these instructions carefully before proceeding.**  
This instruction is used in conjunction with the Installation Guide.

**Important:** Installation shall be carried out exactly according to the manufacturer's instructions otherwise a safety risk can occur if incorrectly installed.

**Warning:** In order to prevent cabinets overturning or falling down they must be used with the wall attachment device/s provided. Before fixing any cabinets to the wall, ensure the wall construction is capable of taking the weight of the loaded cabinet and that appropriate fixings are used. If in doubt, consult an expert.

**Note:** Wall fixing screws are not supplied due to different wall types requiring different fixings.

**Caution:** Some small pieces of hardware could be hazardous to small children. Keep all these items out of reach and do not leave children unattended in the assembly area.

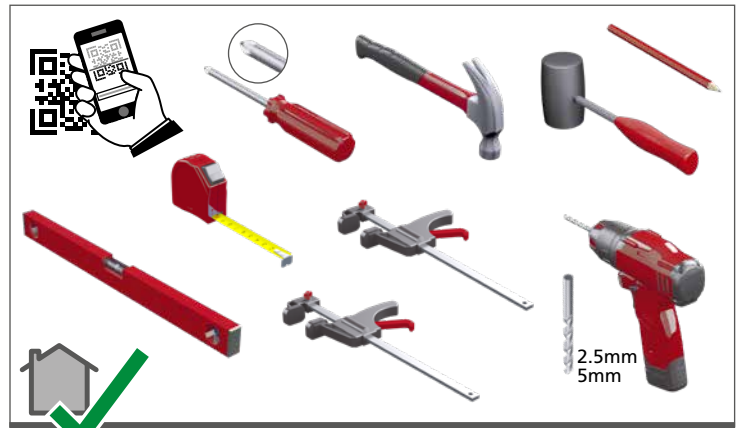

## How the cabinet is supplied.

**1 - 3**

- x2 - Per frontal 94405709
- x2 x4 - 64356003 Ø4x16 RHD
- x8/20 - Single cabinet  
x8/20 - Double cabinet  
94403516 nickel  
94403517 black
- x2 - 94407308  
x4 - 94356602 screw
- 'J' Pull only Pack - 60142607
- Shelf packs supplied separately
- 1 pack per door  
94381720 hinge nickel  
95410006 hinge plate nickel  
95410000 hinge black  
94381788 hinge plate black
- 4 pack - 94401898  
5 pack - 94401899
- 94356602 Ø3.5x15

**Standard Larder Cabinet,**  
(Standard larder illustrated, others similar)

### 1 ① - ③ Attach legs



**Note:** The legs can be attached to either end of the larder cabinet, depending up on the door line required. **CHECK FIRST!**

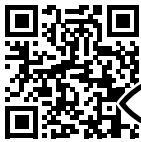
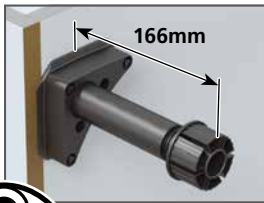

### 2 ① - ③ Secure to wall



**Note:** Wall fixing screws are not supplied due to different wall types requiring different fixings.



x2  
x4 - 64356003 Ø4x16 RHD

### 3 ① - ③ Connecting cabinets

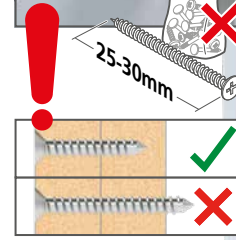

### 4 ① - ③ Door and hinge adjustment

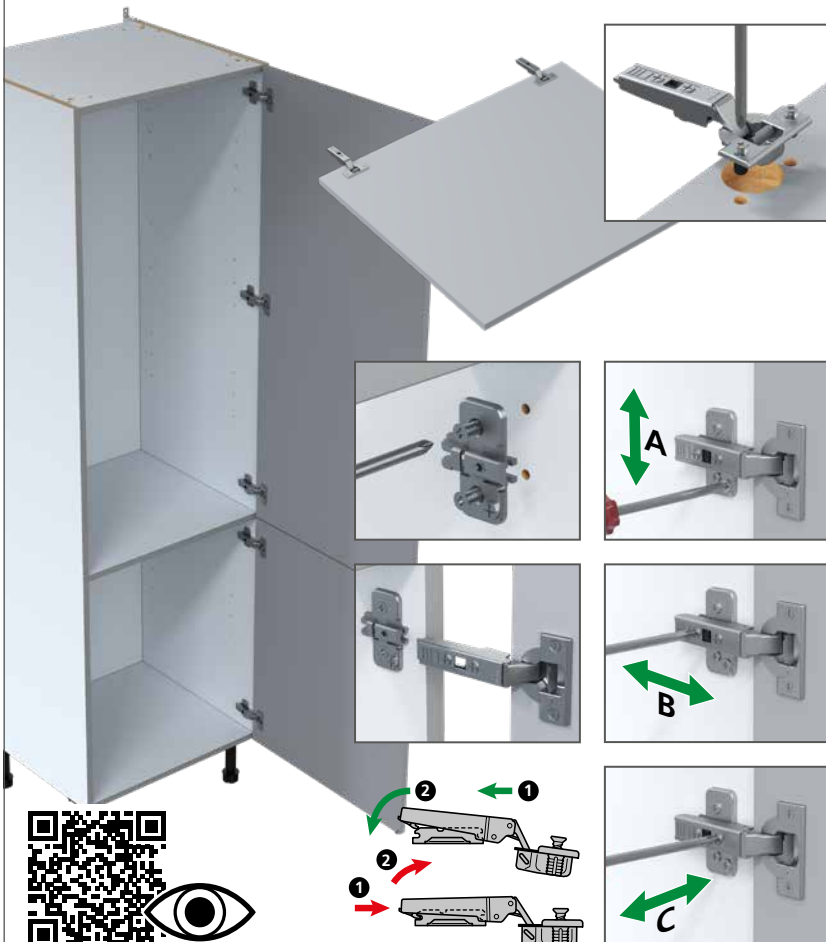

### 5 ① - ③ Fit shelves and joining door

