

# Oven/Combi Unit - 2310mm Tall Housing

This cabinet has a 41mm ventilation gap at the rear. Refer to appliance instructions for further specific ventilation requirements.

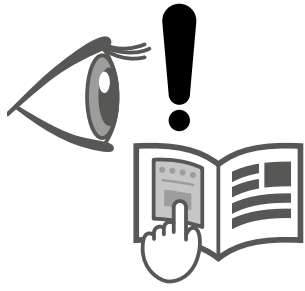

Section 22 lists all housing type configurations.

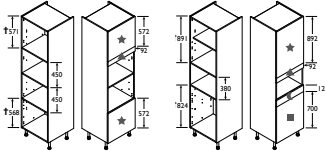

Animation & online instructions

\* An additional shelf pack is supplied separately for units with more than one appliance. Position this shelf using an additional supplied metal bearer pack to minimise the gap between appliances or to line through with adjacent appliances.

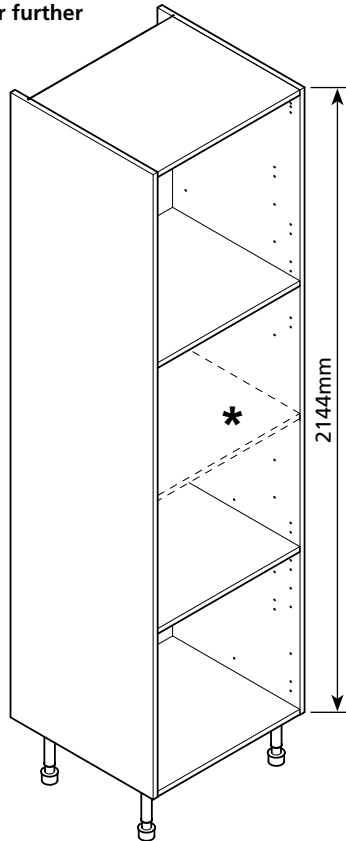

94443789\_0923

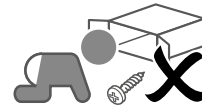

**Important:** Installation shall be carried out exactly according to manufacturer's instructions otherwise a safety risk can occur if incorrectly installed; a warning shall be given to the consumer to notify them of related risks.

**Warning:** For floor standing units intended to be attached to the building: **WARNING** In order to prevent overturning this product must be used with the wall brackets provided.

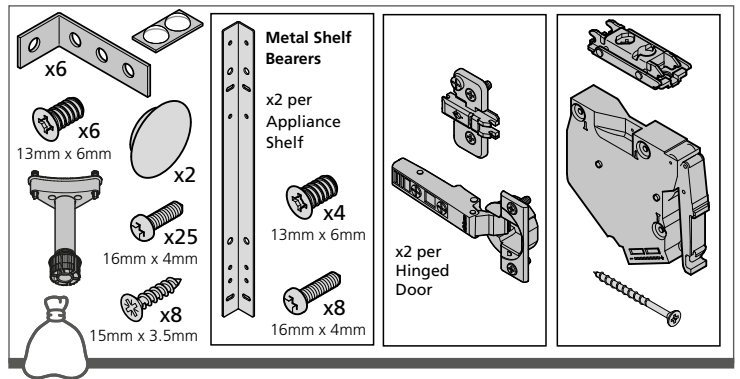
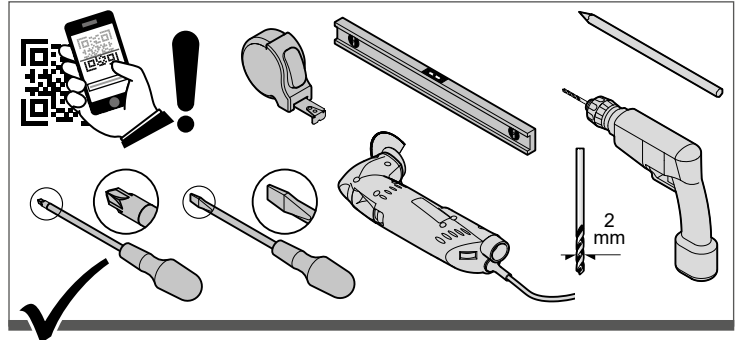

1

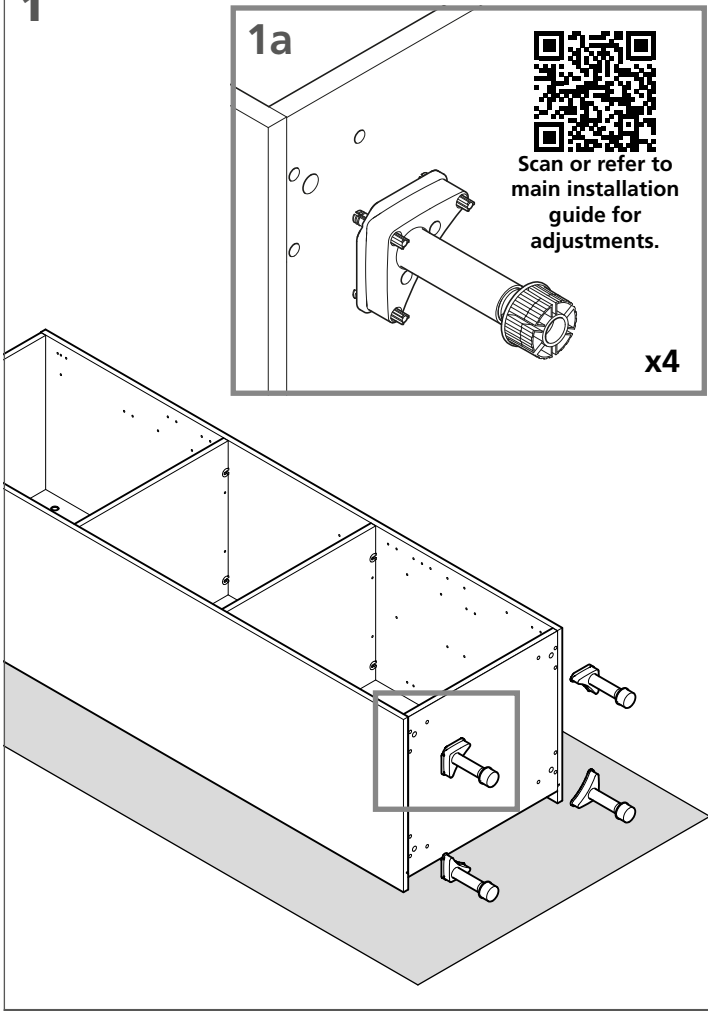

2

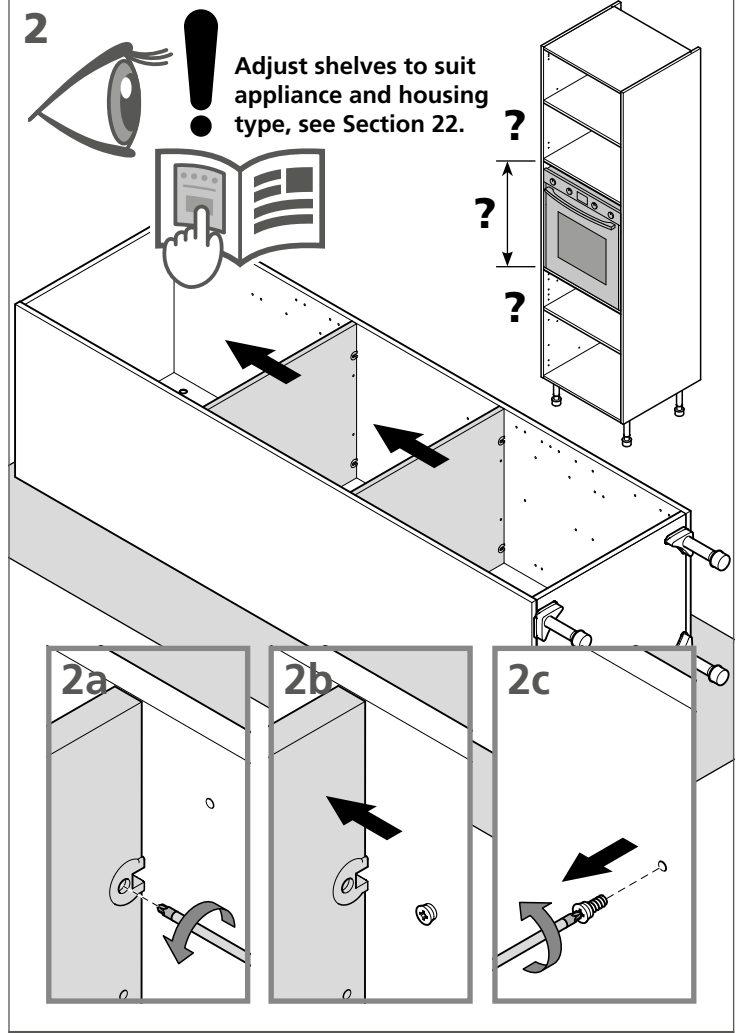

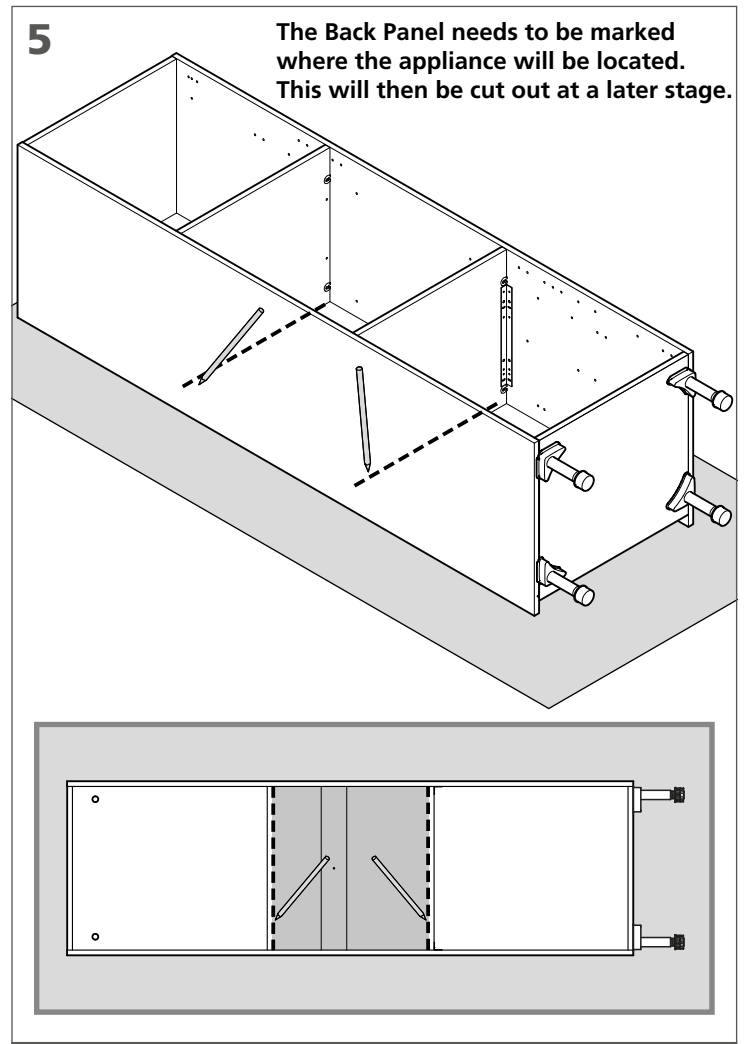
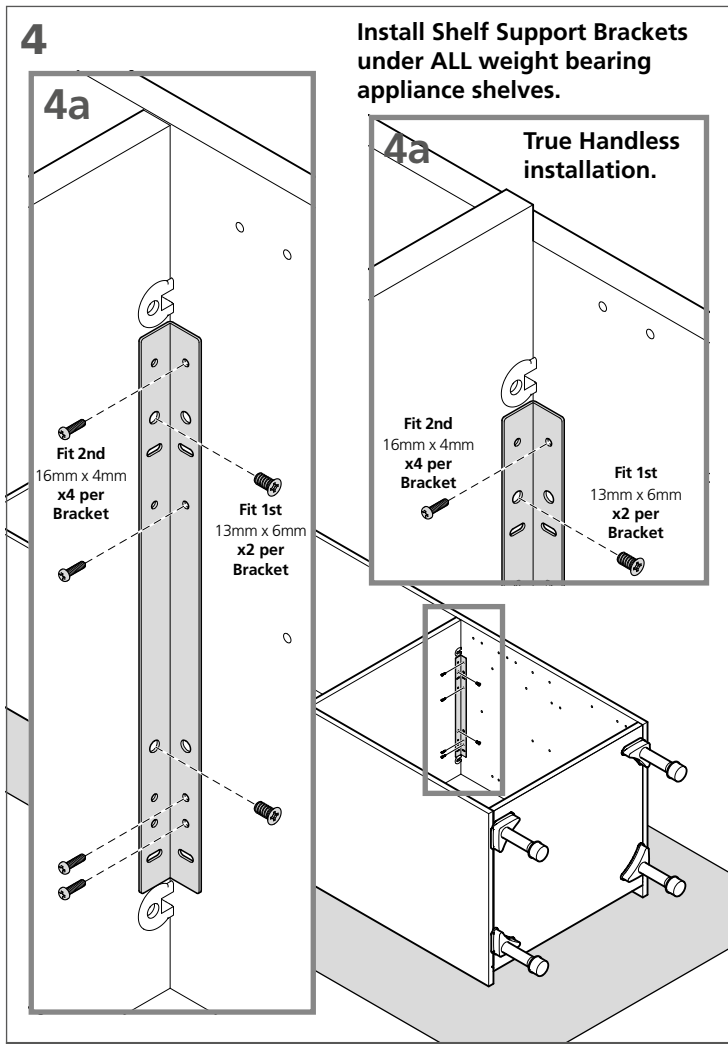
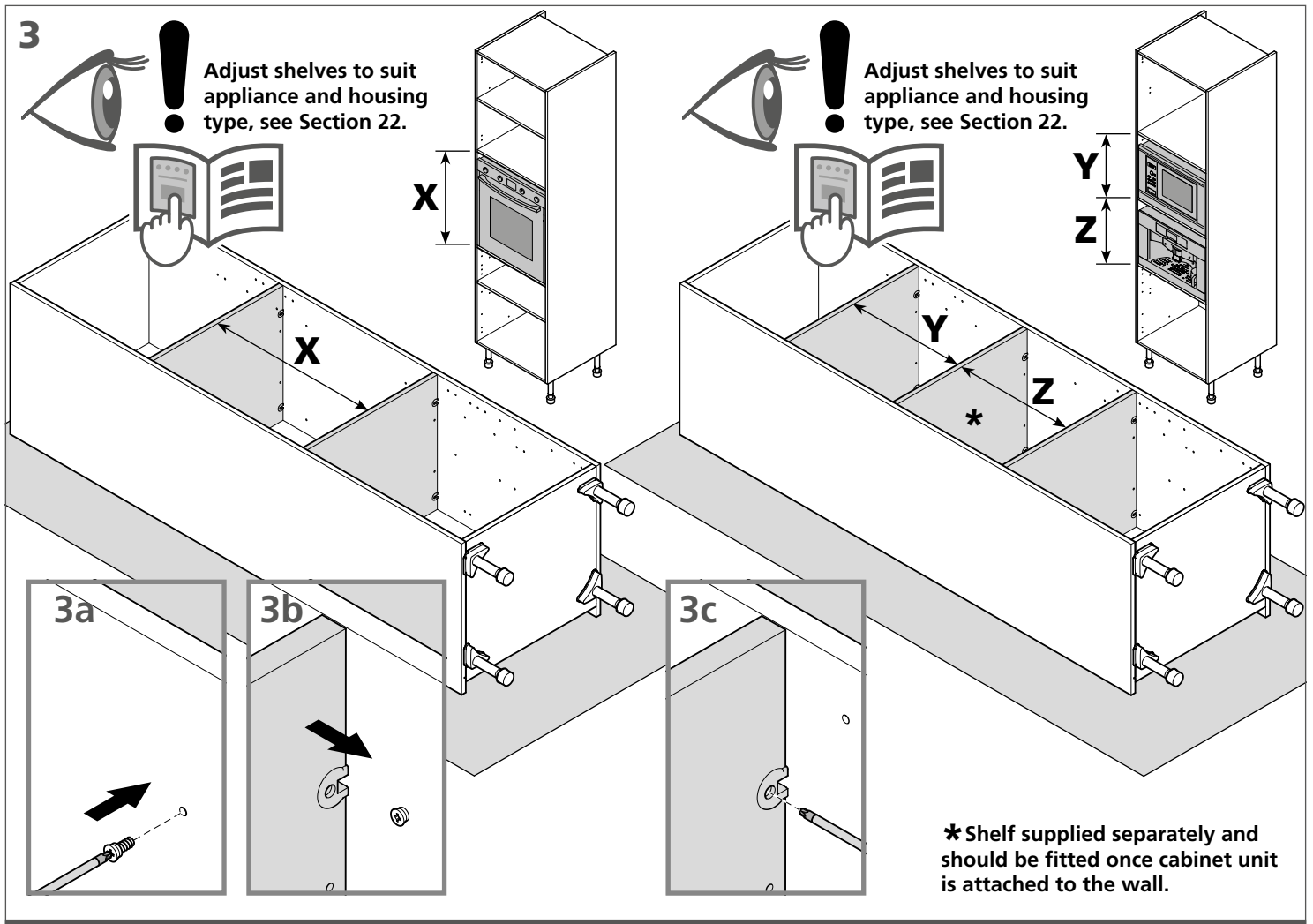

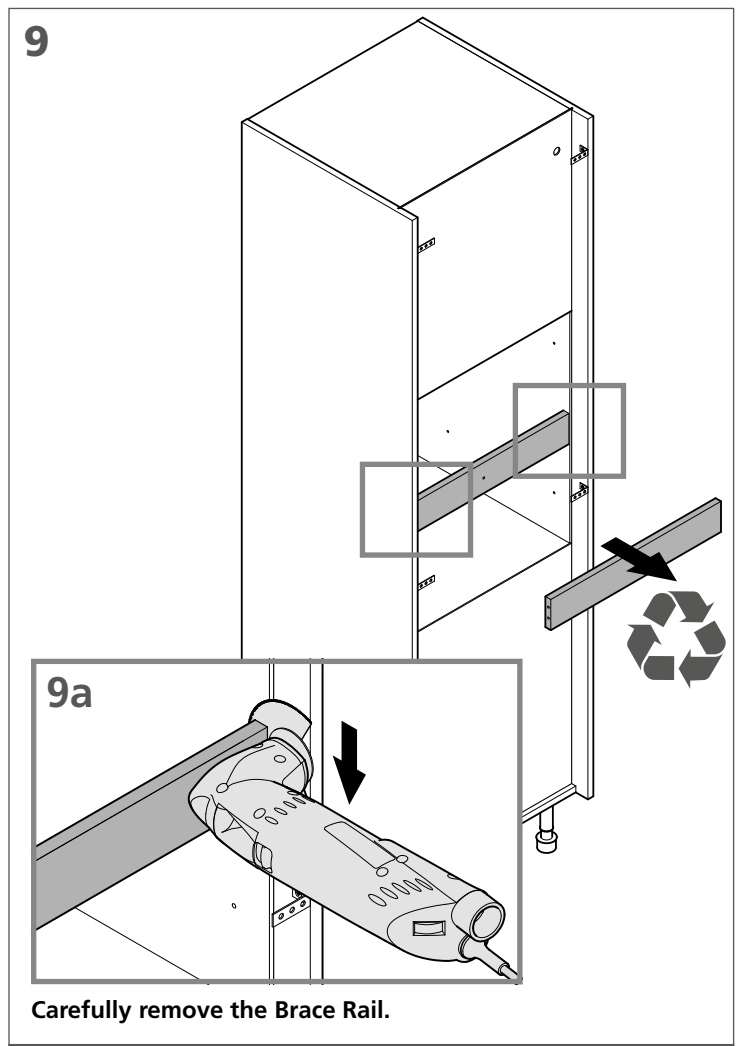
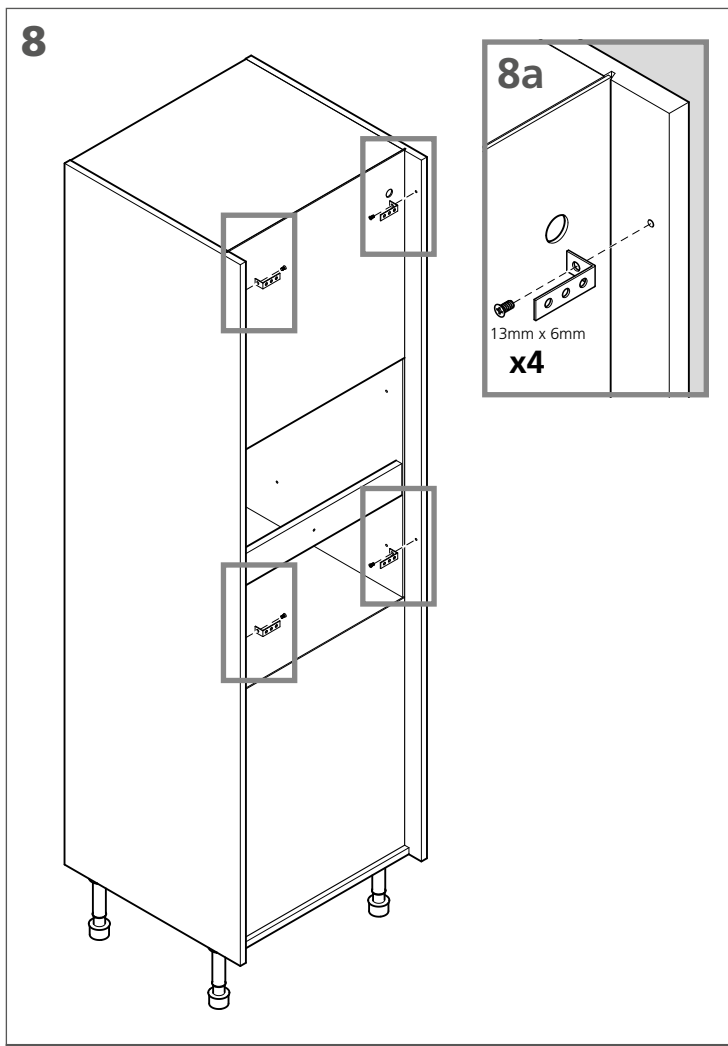
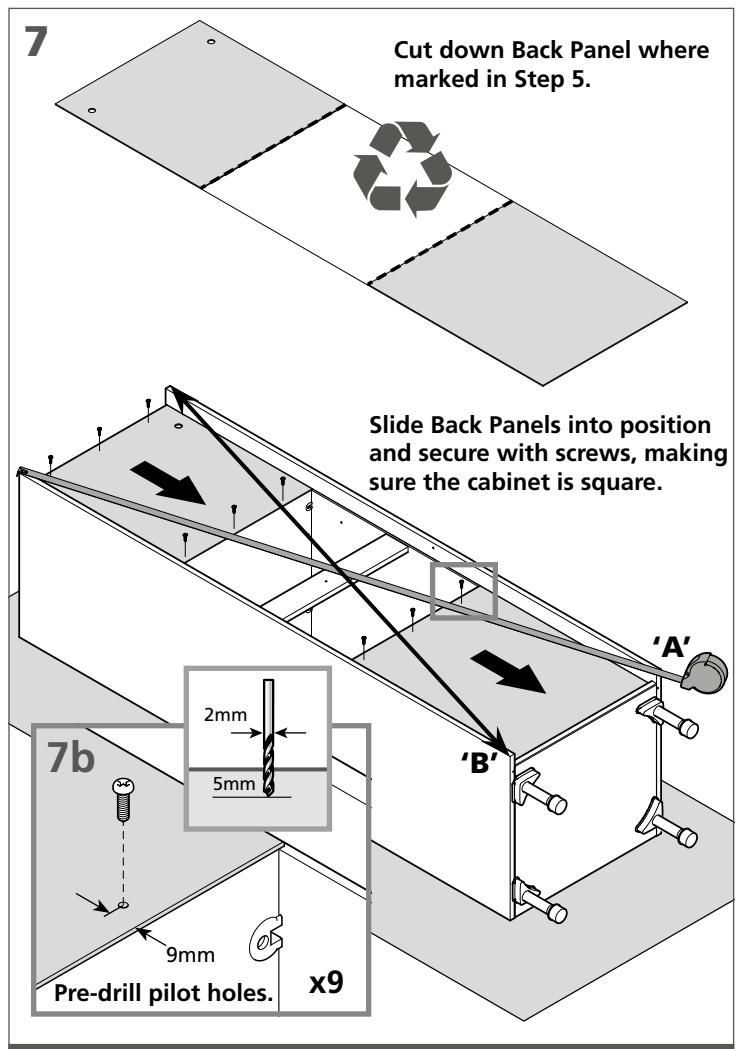
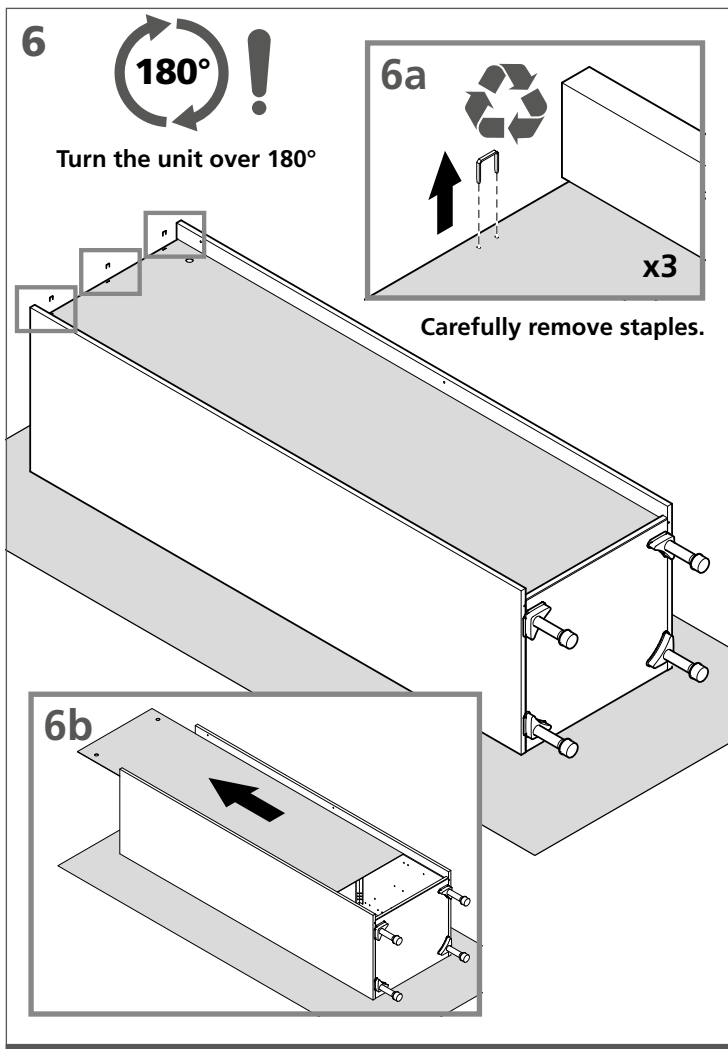

## 10

Wall fixings are NOT supplied, please choose wall fixings to suit wall type.

10a  
10b

10c

10c

10a

x2

10b

x2

10c

x2

## 11 Profit Filler Lock

To install the Filler Frontal, you must first fit the Profit Filler Lock housing before fitting the appliance due to restricted access. The Filler Frontal should then be fitted after the installation of doors and appliance, see Step 17.

11a

11b True Handleless installation position.

50mm

x2

x2

X

Y

Y

**Note:** If installing more than appliance, fit above the upper appliance and shelf.

## 12 Door Hinge Fitment

12a

Fit the Hinge Plates onto the cabinet where required.

12b

Fit the Hinge Arms onto the Door Panel.

12c

Fit the Door Bumpers.

**Note:** Drawers and Frontals should be installed at this stage too. See Stages 18-21 for further details.

## 13 Door Adjustment ★

**Note:** Adjust all the frontals before filler is attached in Step 17.

A

B

C

A

B

C

Soft Close Hinges can be turned on/off via the switch.

## 14 Flap Frontal and Hinge

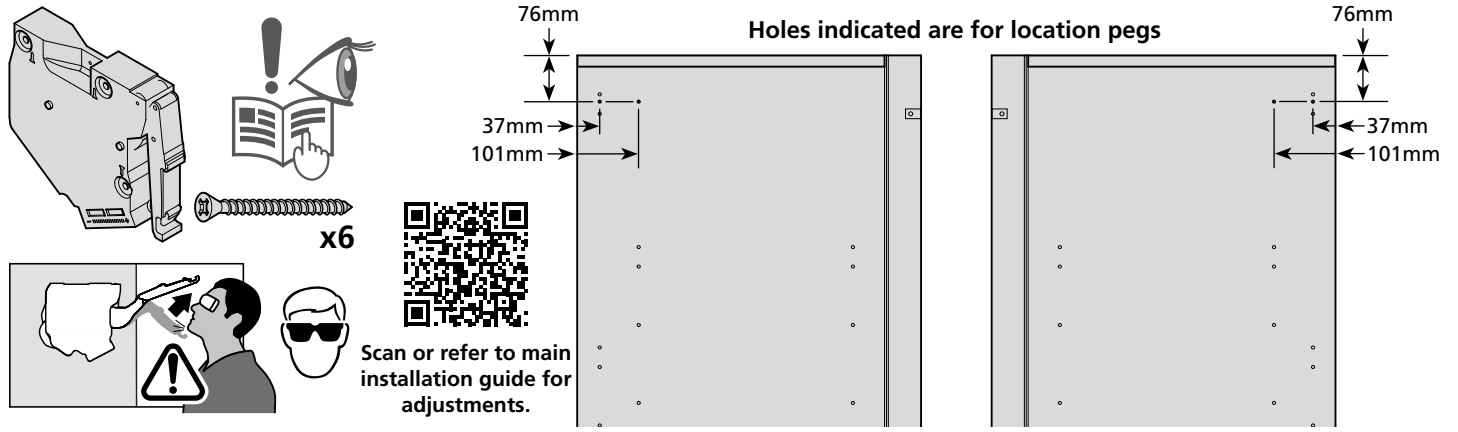

## 15 Flap Frontal and Hinge

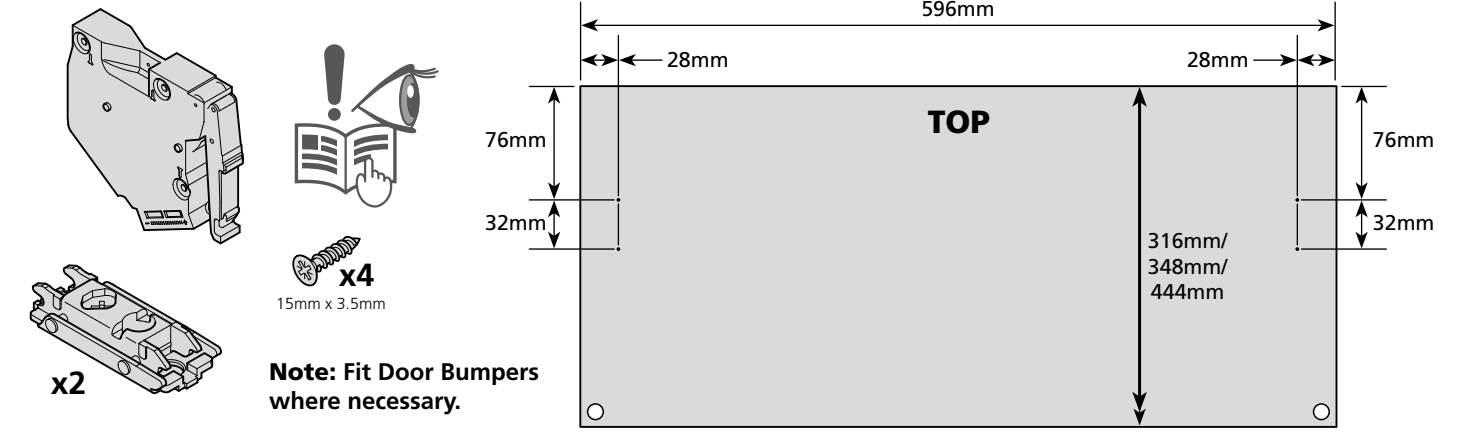

## 16 Appliance Grill Fitting

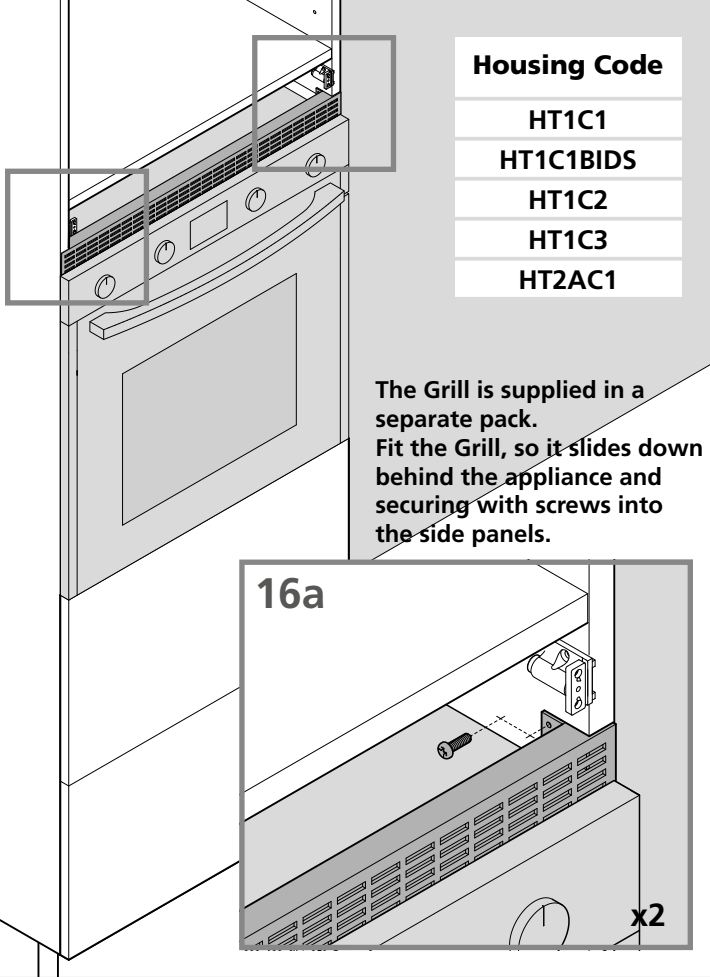

## 17 Filler Frontal/Profit

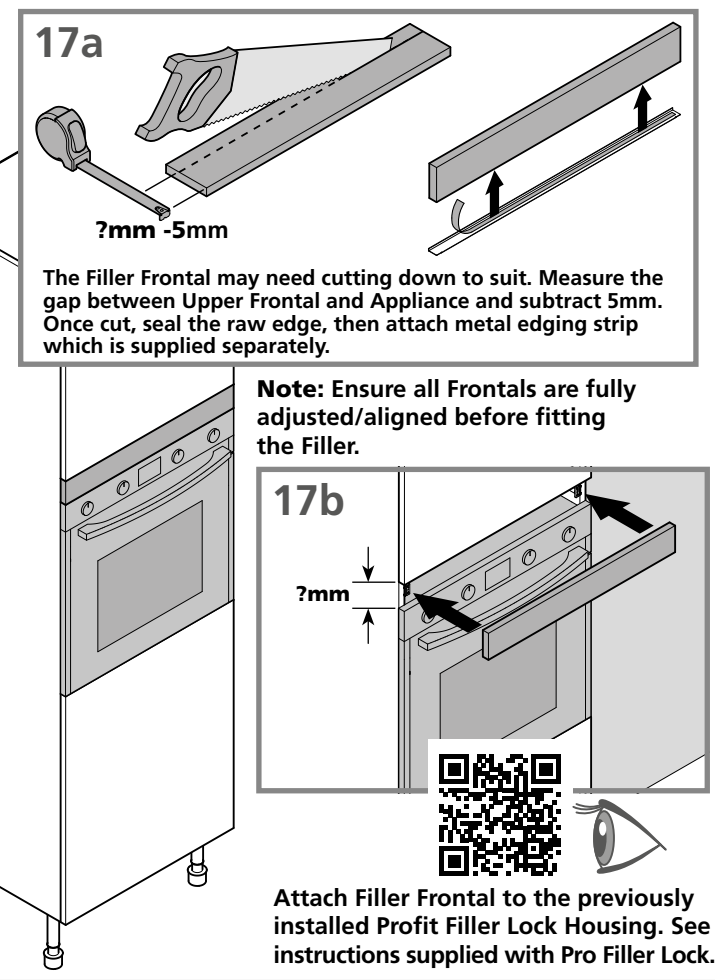

# 18 Blumotion Drawer Types & Runner Screw Fixing

## Blumotion Top Drawer Box

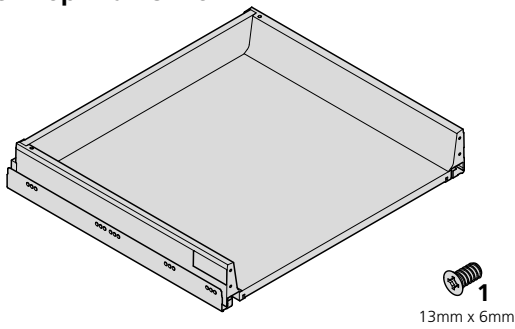

## Blumotion Pan Drawer Box

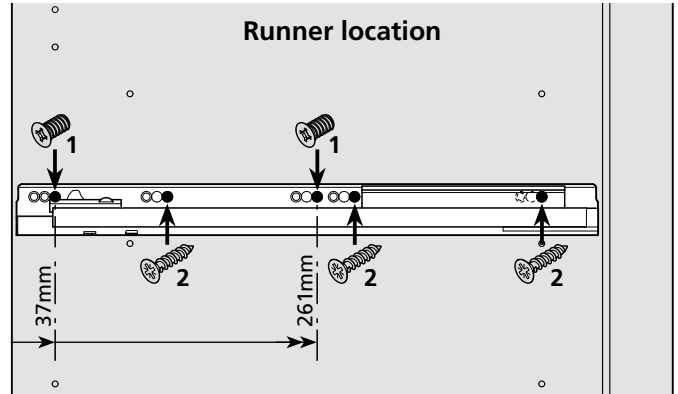
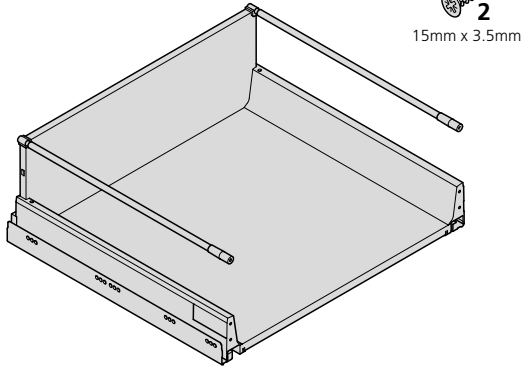

**Note:** Locate the Drawer Runners onto the side panels first using screws (1), then tighten. Finish securing the Runner with screws (2).

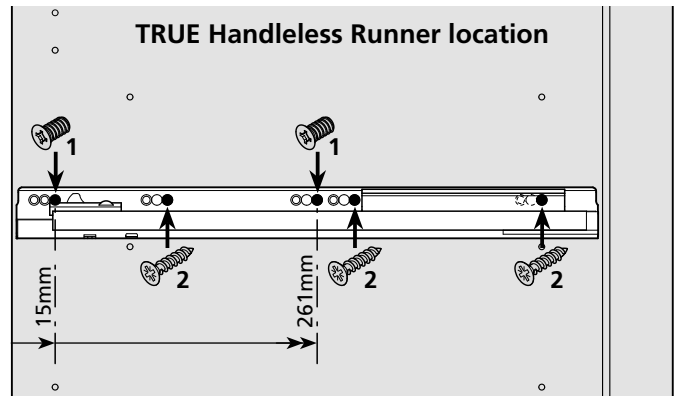

Scan or refer to main installation guide for adjustments.



For Blumotion Drawer Runners Locations, see Section 20.

# 19 Metabox Drawer Types & Runner Screw Fixing

## Metabox Top Drawer Box

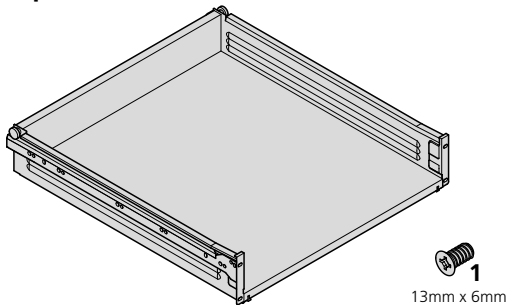

## Metabox Pan Drawer Box

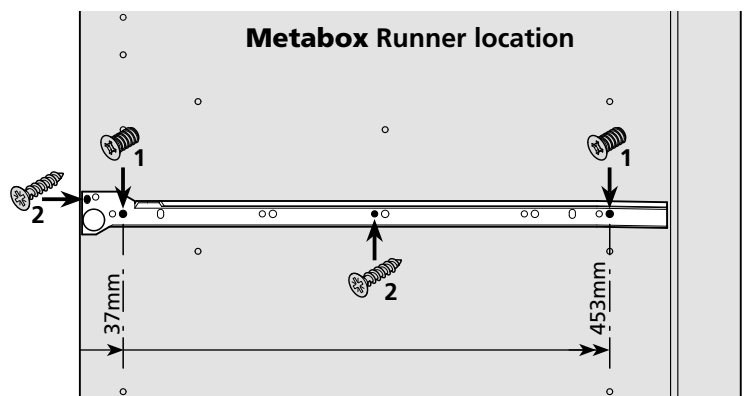
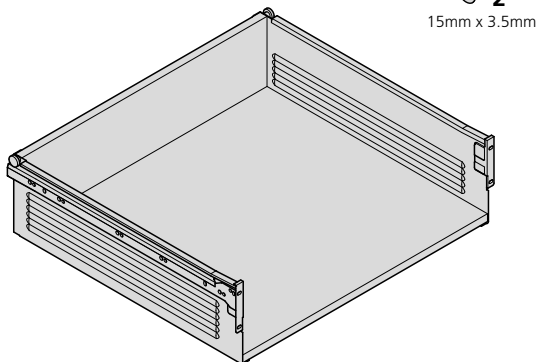

**Note:** Locate the Drawer Runners onto the side panels first using screws (1), then tighten. Finish securing the Runner with screws (2).



Scan or refer to main installation guide for adjustments.



For Metabox Drawer Runners Locations, see Section 21.

# 20 Blumotion Drawer Runner Locations

## 3 Drawer

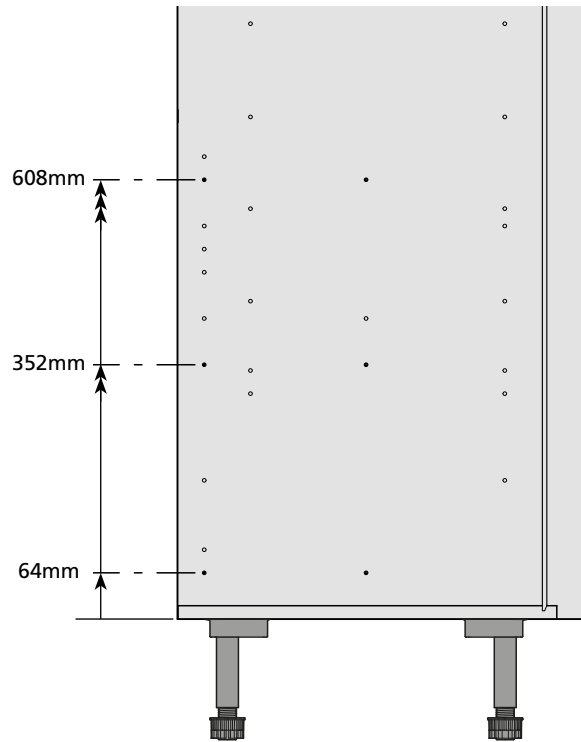
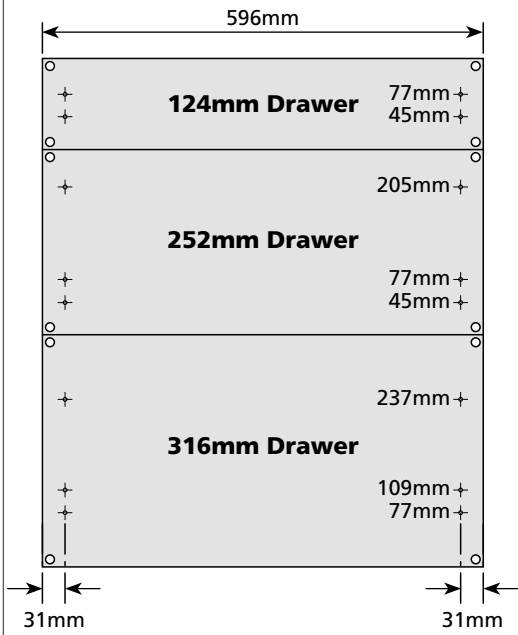

### Housing Code

HT1A3

HT1B3

HT1C3

## 2 Drawer

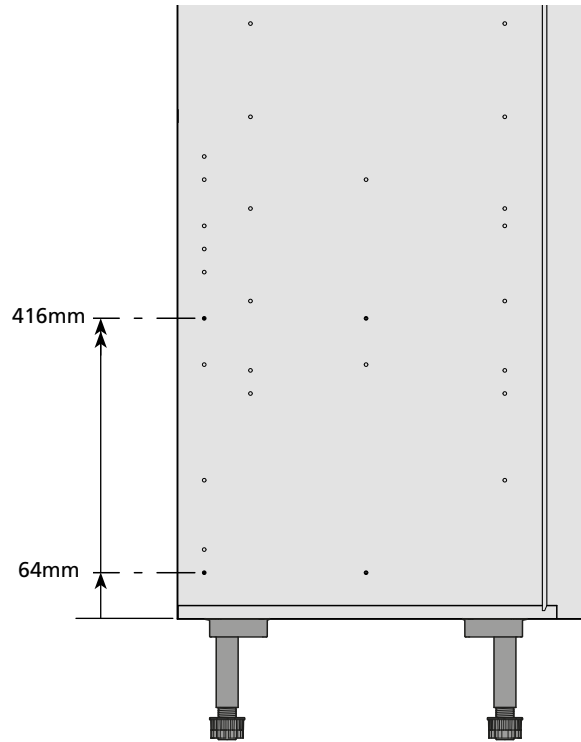
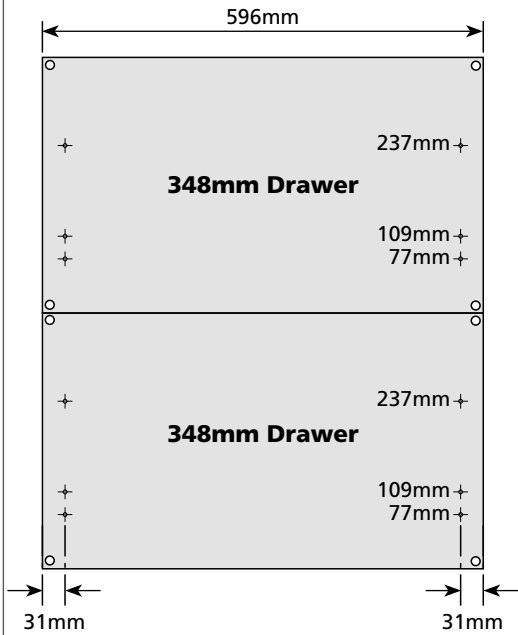

### Housing Code

HT1A2

HT1B2

HT1C2

**Note:** Fit Door Bumpers where necessary.



## 20 Blumotion Drawer Runner Locations (Continued)

### 2 Drawer - Low Height

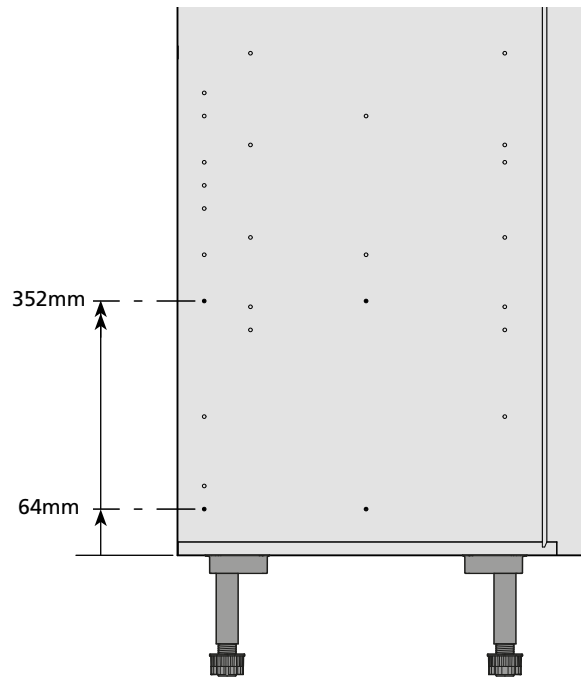
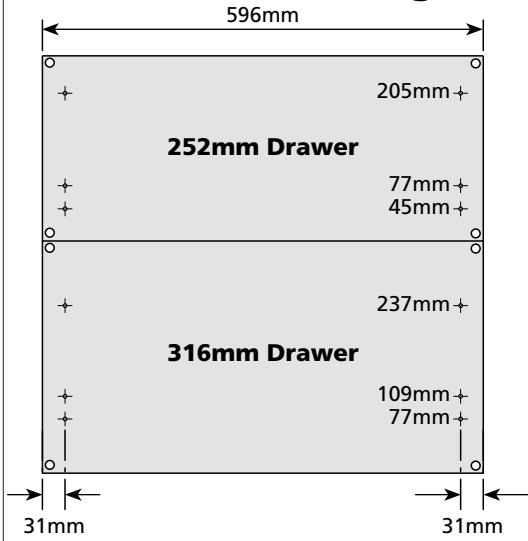

#### Housing Code

HT1D2

HT2BB2

### 700 - Internal Drawer System

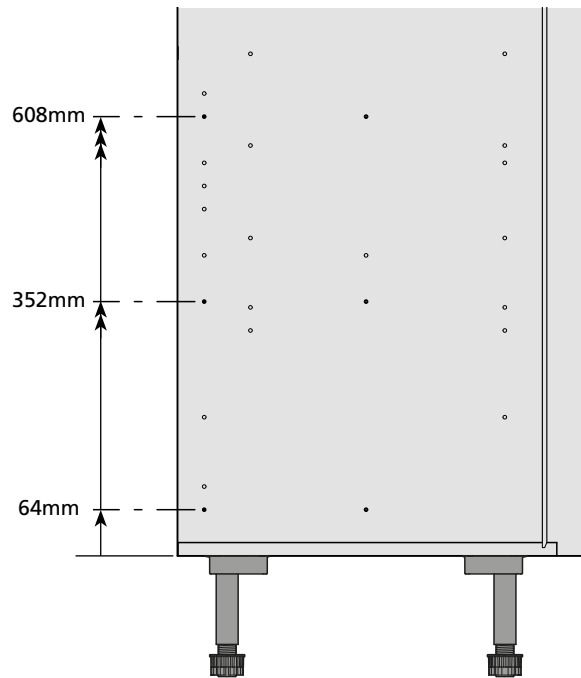
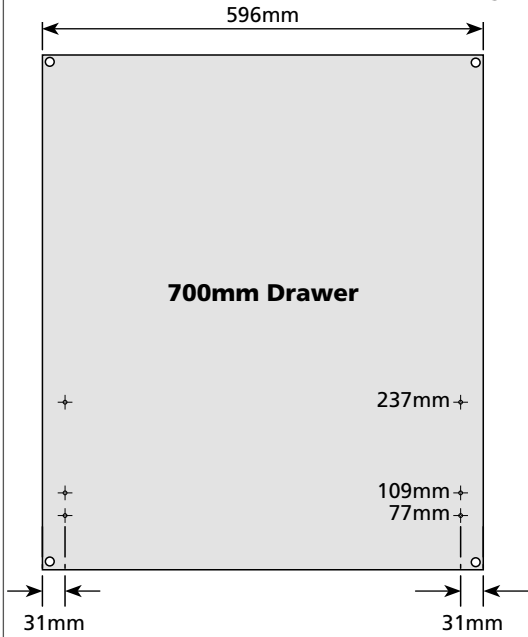

#### Housing Code

HT1A1BIDS

HT1B1BIDS

HT1C1BIDS

### Single Pan Drawer

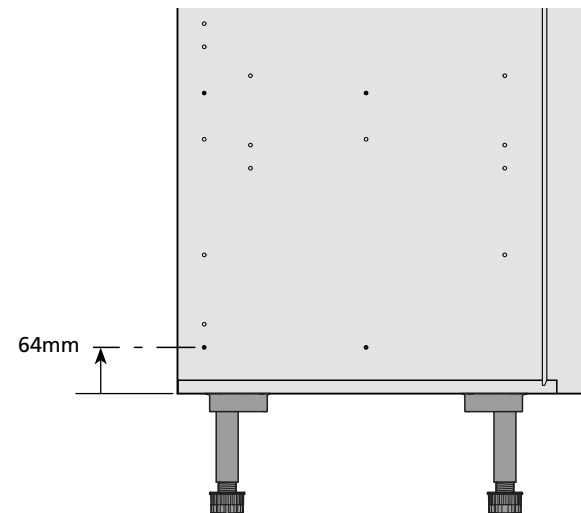
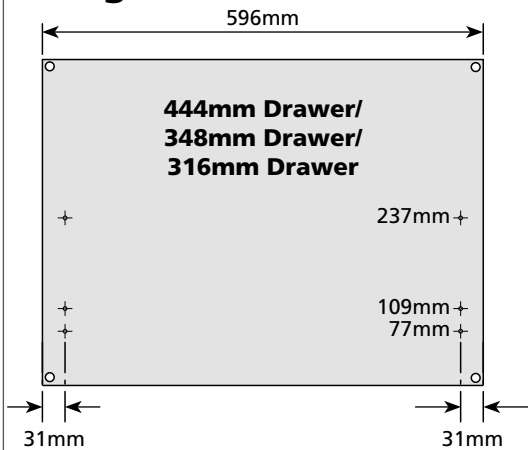

#### Housing Code

HT2AD1

HT2CC1

HT2BD1

Note: Fit Door Bumpers where necessary.



# 21 Metabox Drawer Runner Locations

## 2 Drawer

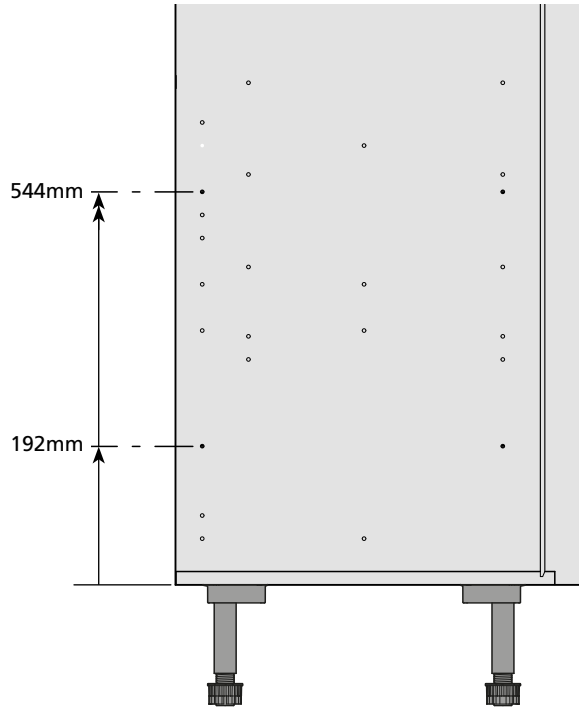
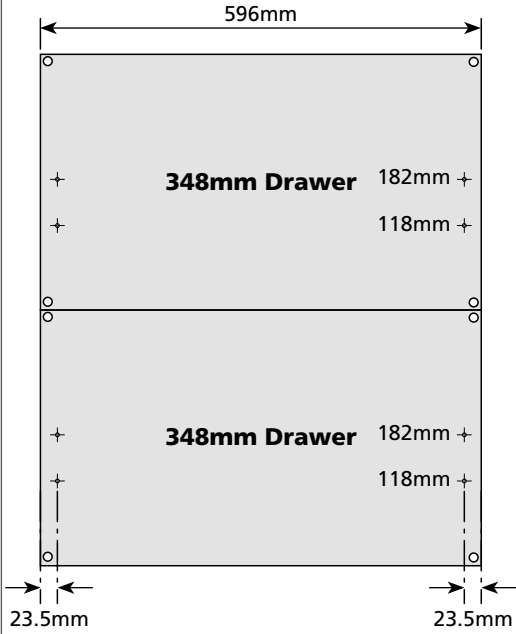

### Housing Code

HT1A2

HT1B2

HT1C2

## 2 Drawer - Low Height

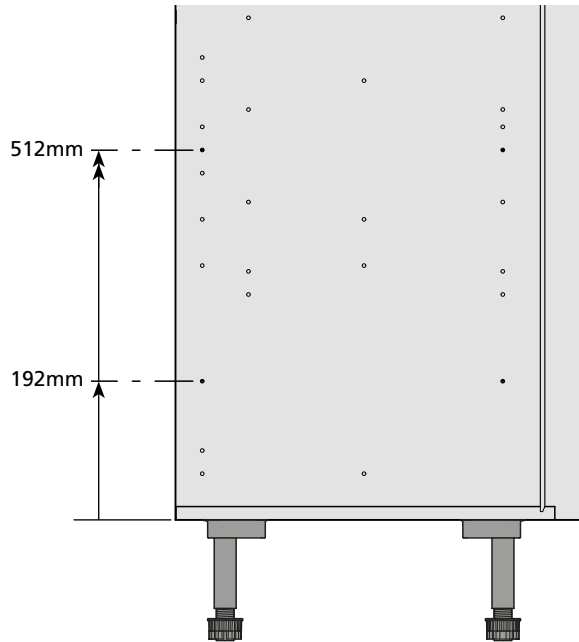
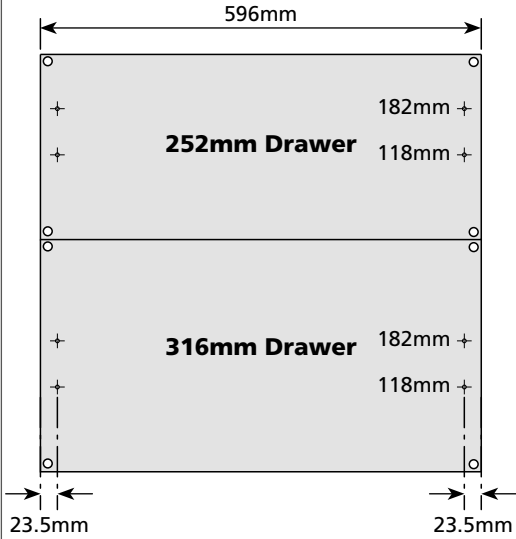

### Housing Code

HT1D2

HT2BB2

## Single Pan Drawer

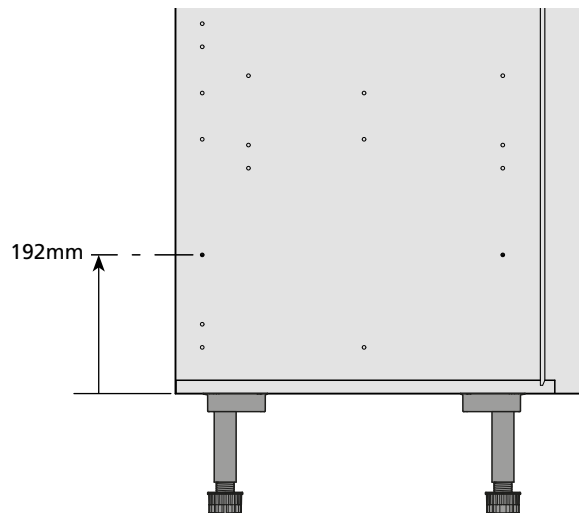
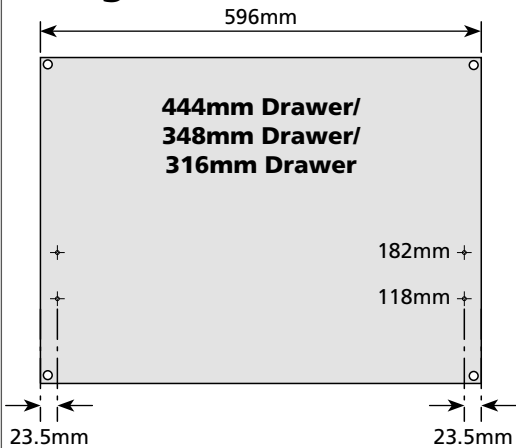

### Housing Code

HT2AD1

HT2CC1

HT2BD1

**Note: Fit Door Bumpers where necessary.**

## 2310mm Tall Appliance Housings Aperture & Frontal Sizes

### Combi appliance housing types - All door types

**Type HT2BB1**

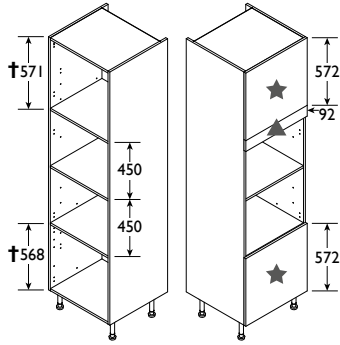

**Type HT2BB2**

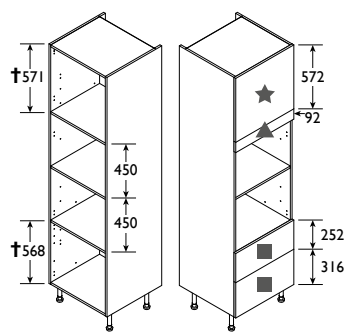

**Type \*HT2AC1**

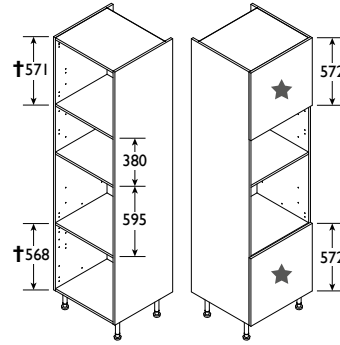

**Type \*HT2BC1**

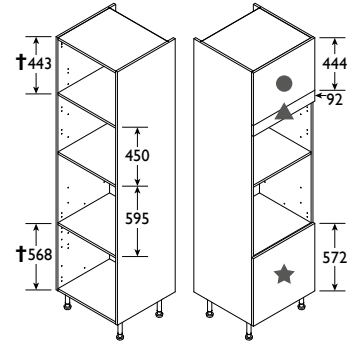

**Type \*\*HT2AD1**

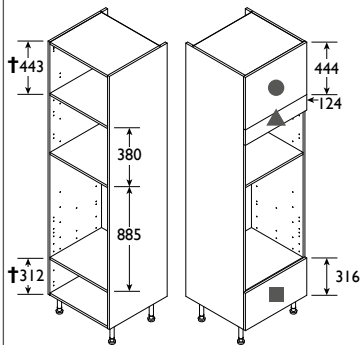

**Type \*HT2CC1**

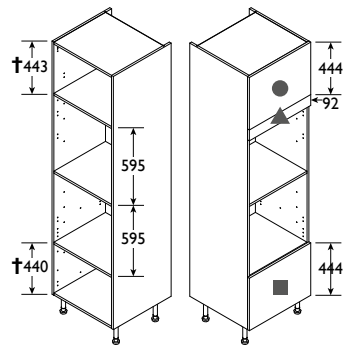

**Type HT2AB1**

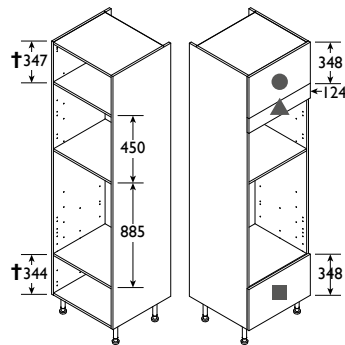

### 380 High Appliances - All door types

**Type HT1A1**

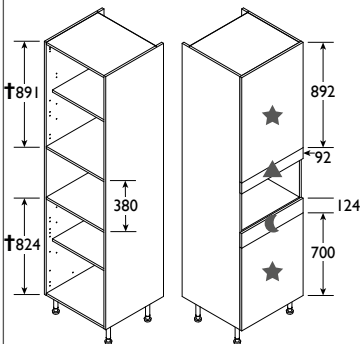

**Type HT1A2**

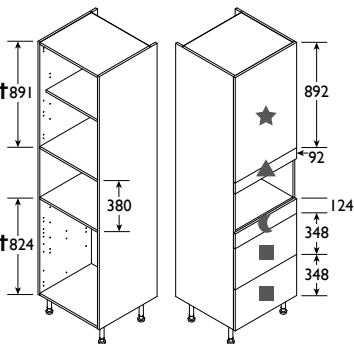

**Type HT1A3**

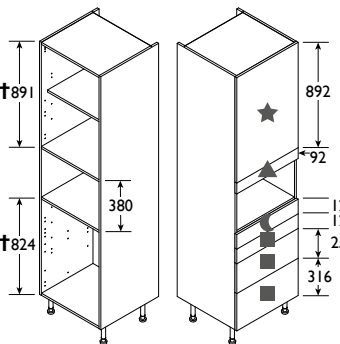

**Type H1A1BIDS**

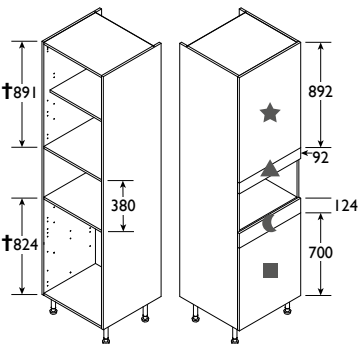

★ = Hinged Frontal   ■ = Drawer Frontal   ● = Flap Frontal   ☾ = Dummy Drawer Frontal   ▲ = Filler Frontal

† Fixed shelf positions. All dimensions are to the centre of the shelf.

**\*HT2AC1, HT2BC1, HT2CC1, HT1C1, HT1C2, HT1C3, HT1C1BIDS**

Current aperture of 595mm can be used with 140mm OR 150mm warming drawer + 450mm appliance.

**\*\*HT2AD1, HT1D1, HT1D2**

Current aperture of 885mm can be used with 290mm warming drawer + 595mm appliance.

The filler size indicated is the supplied panel size. In most cases, the filler requires trimming to suit the specific appliance size. Seal any raw edges and attach the strip supplied, See Step 17.

**Important:** Please refer to the appliance manufacturer's fitting instructions as improper fitting may invalidate the appliance manufacturer's warranty.

Make sure that the appliances are accessible and can be removed from the carcass if service is necessary.

Ensure the units are properly vented as required by the appliance manufacturer.

# 22 2310mm Tall Appliance Housings (Continued) Aperture & Frontal Sizes

## 450 High Appliances - All door types

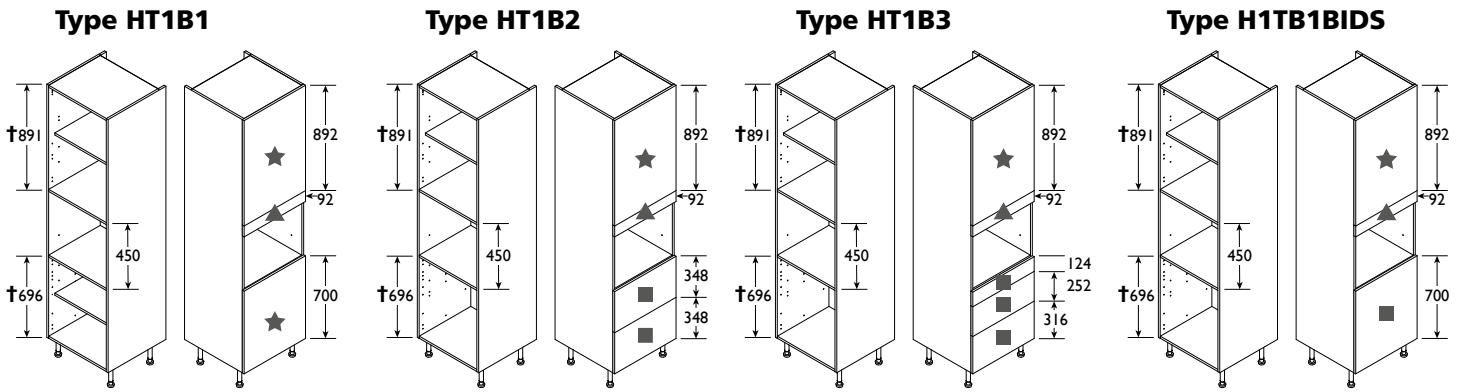

## 600 High Appliance housing types - All door types

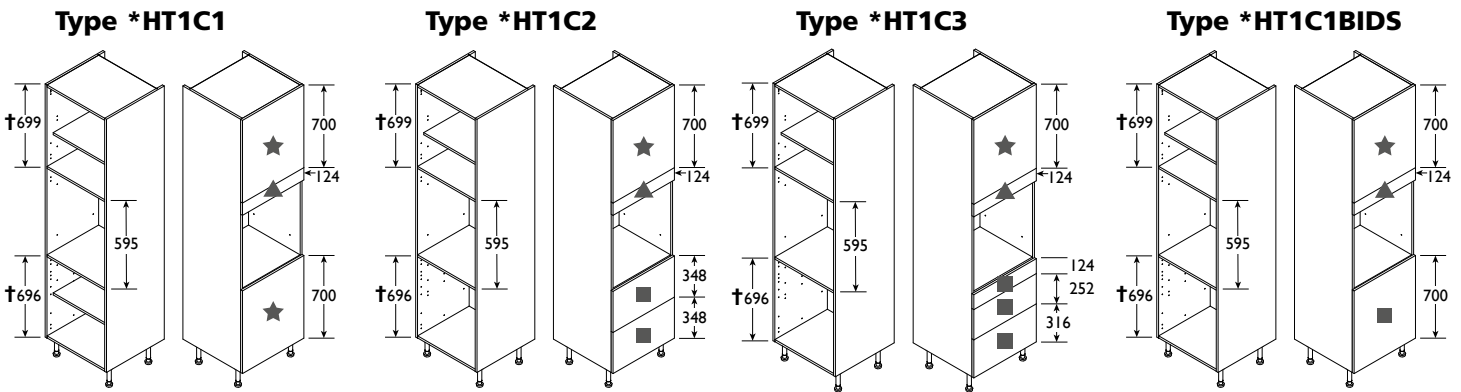

★ = Hinged Frontal   ■ = Drawer Frontal   ● = Flap Frontal   ◐ = Dummy Drawer Frontal   ▲ = Filler Frontal

† Fixed shelf positions. All dimensions are to the centre of the shelf.

\*HT2AC1, HT2BC1, HT2CC1, HT1C1, HT1C2, HT1C3, HT1C1BIDS

Current aperture of 595mm can be used with 140mm OR 150mm warming drawer + 450mm appliance.

\*\*HT2AD1, HT1D1, HT1D2

Current aperture of 885mm can be used with 290mm warming drawer + 595mm appliance.

The filler size indicated is the supplied panel size. In most cases, the filler requires trimming to suit the specific appliance size. Seal any raw edges and attach the strip supplied, See Step 17.

**Important:** Please refer to the appliance manufacturer's fitting instructions as improper fitting may invalidate the appliance manufacturer's warranty.

Make sure that the appliances are accessible and can be removed from the carcass if service is necessary.

Ensure the units are properly vented as required by the appliance manufacturer.

# 22 2310mm Tall Appliance Housings (Continued) Aperture & Frontal Sizes

## 800 High Appliance housing types - All door types

**Type HT1E1**

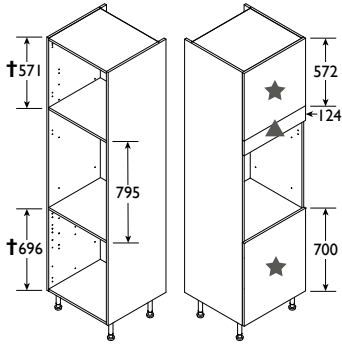

**Type HT1E2**

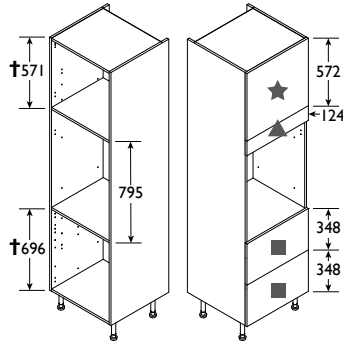

**Type HT1E3**

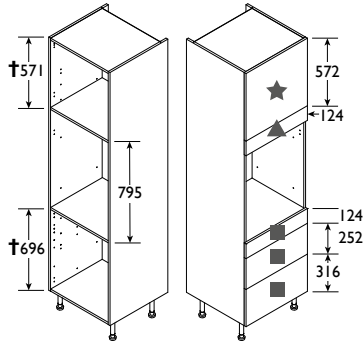

## 900 High Appliance housing types - All door types

**Type \*\*HT1D1**

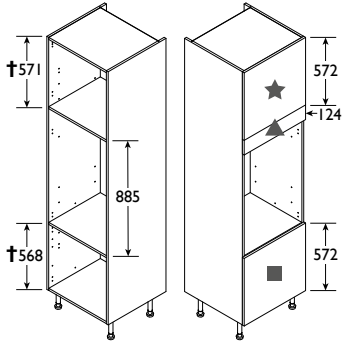

**Type \*\*HT1D2**

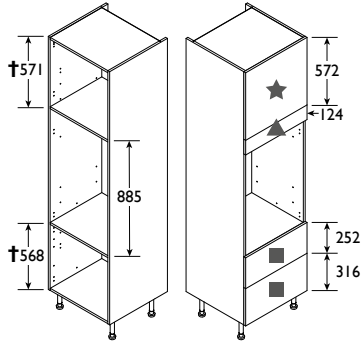

★ = Hinged Frontal   ■ = Drawer Frontal   ● = Flap Frontal   ☾ = Dummy Drawer Frontal   ▲ = Filler Frontal

† Fixed shelf positions. All dimensions are to the centre of the shelf.

**\*HT2AC1, HT2BC1, HT2CC1, HT1C1, HT1C2, HT1C3, HT1C1BIDS**  
Current aperture of 595mm can be used with 140mm OR 150mm warming drawer + 450mm appliance.

**\*\*HT2AD1, HT1D1, HT1D2**  
Current aperture of 885mm can be used with 290mm warming drawer + 595mm appliance.

The filler size indicated is the supplied panel size. In most cases, the filler requires trimming to suit the specific appliance size. Seal any raw edges and attach the strip supplied, See Step 17.

**Important:** Please refer to the appliance manufacturer's fitting instructions as improper fitting may invalidate the appliance manufacturer's warranty.

Make sure that the appliances are accessible and can be removed from the carcass if service is necessary. Ensure the units are properly vented as required by the appliance manufacturer.

## 23 Shelf for Hinged Doors

